



STOMACHER 100 ml

MiniMix® 100 W CC is the smallest lab blender in the world. Thanks to its digital screen and window door, control easily the speed and time of blending of your MiniMix® 100 W CC and enjoy a ready-to-analyze sample, with no risk of crosscontamination in less than 60 seconds.



TECHNICAL SPECIFICATIONS

- All stainless steel 304L
- Window door
- Multifunction digital screen
- Useful volume: 5 - 80 mL
- Variable speed (3 - 6 - 9 - 12 strokes/s)
- Variable blending time (1 s - 1 h or ∞)
- Adjustable blending power (patented)
- Click & Clean® removable paddles (patented)
- Side-by-side paddle stop
- Q-Tight® closing: tight closing for no more leaks from the top of the bag
- Fully opening door (270°)
- Security drip tray
- Voltage and frequency: 100-127V~ / 220-240V~ 50-60Hz
- Fuses: T 3.15A L 240V / T 1.25A L 5x20 mm
- Max power: 110 W
- Dimensions (w x d x h): 20 x 37.5 x 20 cm, weight: 11.8 kg
- Box (w x d x h): 50 x 30 x 33 cm, weight: 13.4 kg
- In compliance with: ISO 7218, ISO 6887-1 and FDA BAM (Bacteriological Analytical Manual)
- Manufactured under CE, RoHS, WEEE - Products made for INTERSCIENCE by Interlab, an ISO 9001 certified company
- Designed and made in France

Standards:

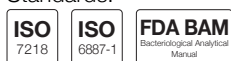

Manufactured under:



Product made for INTERSCIENCE by Interlab, an ISO 9001 certified company

DELIVERED WITH

- 1 security drip tray
- 1 power cable
- 1 user's manual
- 1 quick user guide
- 1 free pack of blender bags

Applications



• Food microbiology



• Pharmaceutical

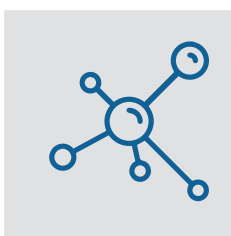

• Molecular extraction

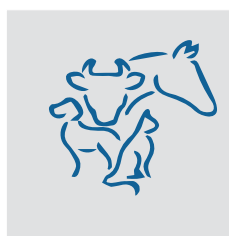

• Veterinary, clinical (biopsies, organ sampling...)



• Toxin research (HPLC, GCMS...)

Advantages

- Compact, silent
- User friendly
- Optimal extraction
- Lifetime warranty on window door and shock absorbers
- Stainless steel
- Q-Tight®: Leak-tight
- Easy and total cleaning

1 Multifunction screen

For easy control of the blending parameters

Blending time

Blending speed

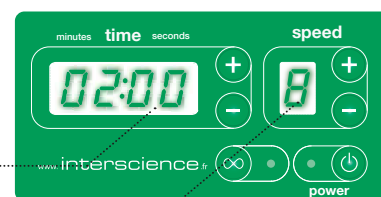



2 Q-Tight® system

A special closing system that avoids every risk of leaking.

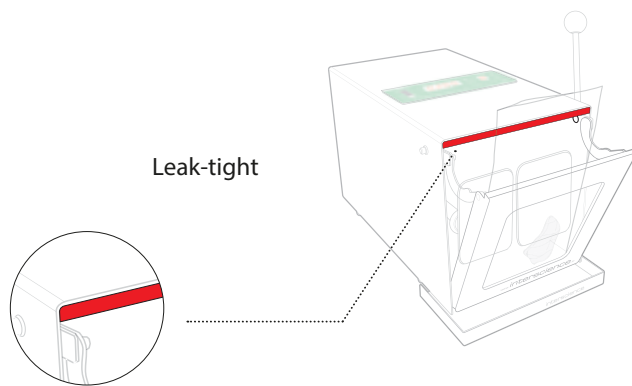

3 Adjustable blending strength

You can adapt the blending chamber to the size of the sample to get OPTIMAL EXTRACTION

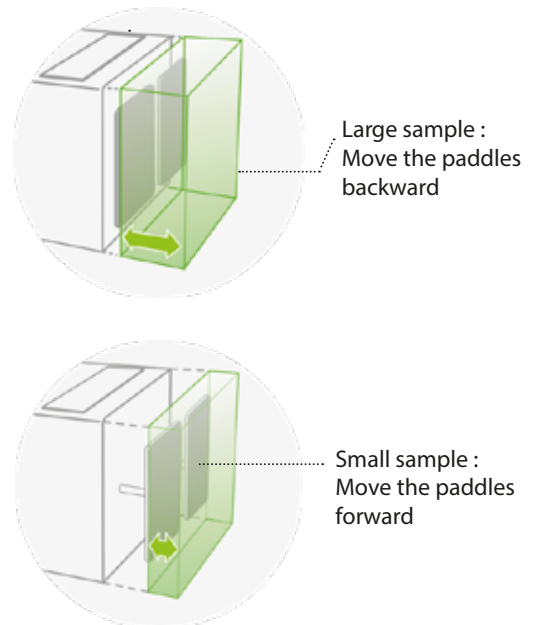

4 Click & Clean® system

UNIQUE! TOTAL CLEANING of the blending chamber is possible!



5 Side-by-side paddle stop

For easy and fast insertion of your sterile bags in the blender.

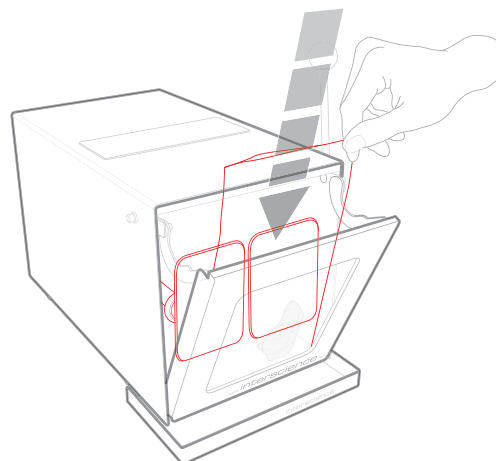



Also available



MiniMix® 100 P CC

- Variable blending speed (3-12 strokes/s)
- Variable blending time (1 - 1h or ∞)
- Available in CoolMix ° version



BagPage® 80 & 100

Full page sterile filter bags

Robust & food compatible, multilayer.



BagLight® 100

Plain sterile bags

Made of PolySilk °, extremely robust. For samples that do not require any filtration.



BagOpen® 100

Bag opener

Easy opening, extremely stable. Resistant to cleaning agents.



DiluFlow®

Gravimetric dilutor

Automatically dilutes with the appropriate mass of solvent.



BagClip® 100

Closing clips

100% watertight & waterproof, closes any kind of bag.

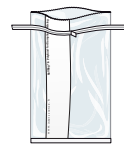

RollBag®

Sampling bag

For collecting, sampling & preservation of any sample. Stands up alone.



BagRack® 100

Storage rack

Stainless steel, autoclavable.

Discover our complete range for microbiology

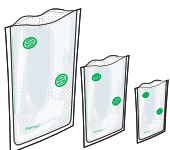

BagFilter®
Sterile bags



DiluFlow®
Gravimetric dilutors



FlexiPump®
Peristaltic pumps



easySpiral Dilute®
Serial dilutors and platers



Scan®
Colony counters